

LAND AREA (AS PER DEED)  
 = 09KH. - 04CH. - 00 SFT  
 = 618.729 Sqm.

LAND AREA (AS PER BOUNDARY DECLARATION)  
 = 09KH. - 01CH. - 10.847 SFT  
 = 607.195 Sqm.

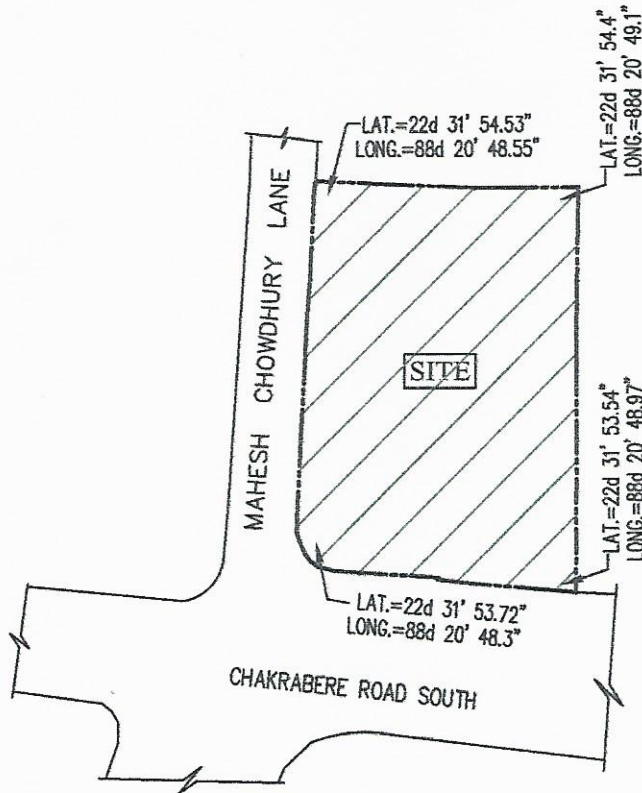

LOCATION PLAN WITH CO-ORDINATES

SIGNATURE OF OWNER

*Raj Kumar Agarwal*

Rajkumar Agarwal  
 Architect  
 Member of Council of  
 Architecture CA / 94 / 17940

SIGNATURE OF ARCHITECT

TITLE

LOCATION PLAN WITH CO-ORDINATES

PROJECT

PROPOSED PLAN OF G+V STORED RESIDENTIAL BUILDING (HT. 19.975 M. ) AT  
 K.M.C. PREMISES NO. - 6, CHAKRABERE ROAD SOUTH, WARD NO.- 70, BR. NO.-  
 VIII, P.S.- BHOWANIPORE, KOLKATA - 700 025.

DATE	DRG.NO	DEALT	CHECKED	SHEET.NO
19.04.2023	ARCH/701/2020	SMRITI		

SCALE 1:600 ARCHITECT



RAJ AGRAWAL & ASSOCIATES  
 8B, ROYD STREET, CALCUTTA-16